

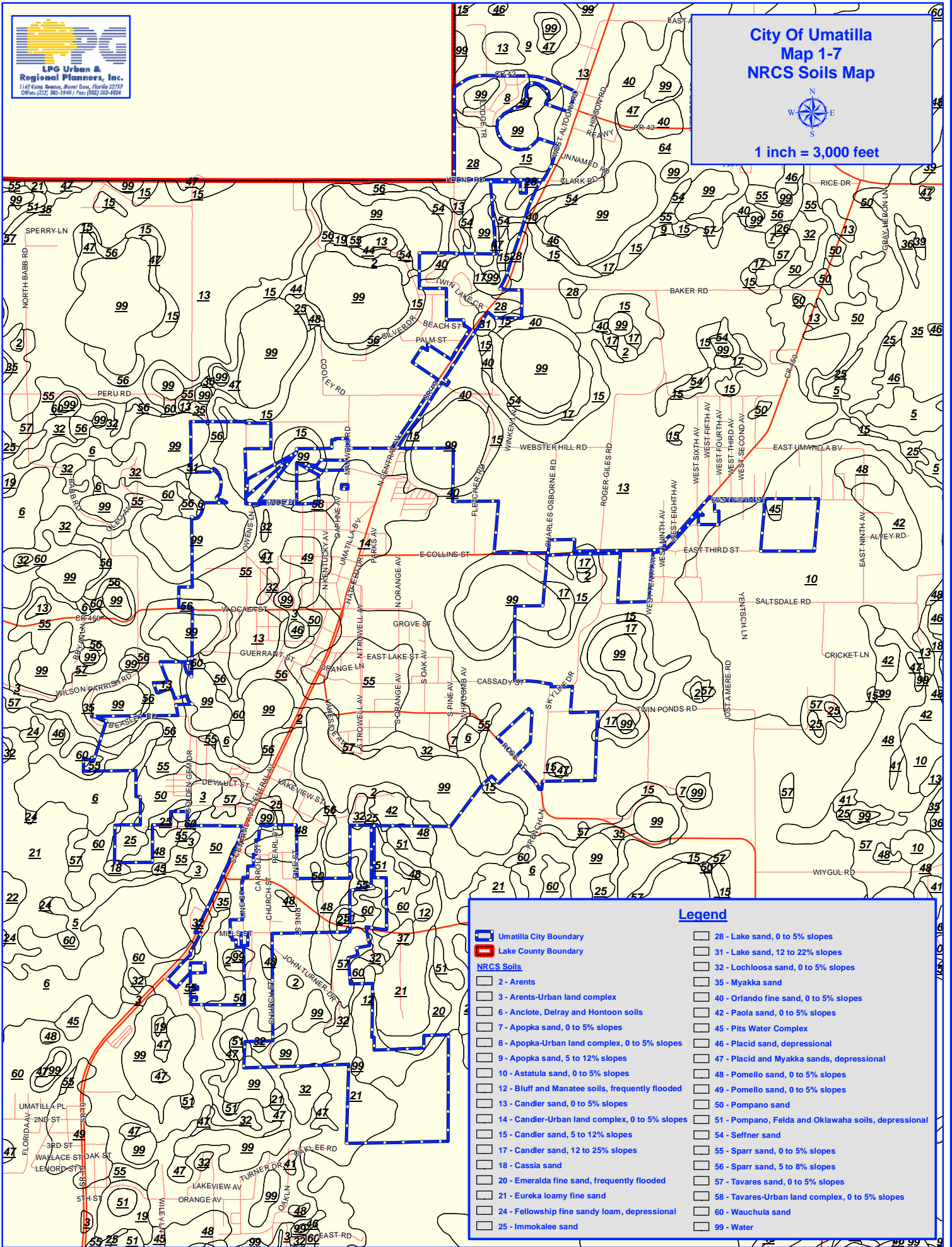

City Of Umatilla
Map 1-7
NRCS Soils Map

1 inch = 3,000 feet



Legend

Umatilla City Boundary	28 - Lake sand, 0 to 5% slopes
Lake County Boundary	31 - Lake sand, 12 to 22% slopes
NRCS Soils	32 - Lochloosa sand, 0 to 5% slopes
2 - Arents	35 - Myakka sand
3 - Arents-Urban land complex	40 - Orlando fine sand, 0 to 5% slopes
6 - Anclote, Delray and Hontoon soils	42 - Paola sand, 0 to 5% slopes
7 - Apopka sand, 0 to 5% slopes	45 - Pits Water Complex
8 - Apopka-Urban land complex, 0 to 5% slopes	46 - Placid sand, depressional
9 - Apopka sand, 5 to 12% slopes	47 - Placid and Myakka sands, depressional
10 - Astatula sand, 0 to 5% slopes	48 - Pomello sand, 0 to 5% slopes
12 - Bluff and Manatee soils, frequently flooded	49 - Pomello sand, 0 to 5% slopes
13 - Candler sand, 0 to 5% slopes	50 - Pompano sand
14 - Candler-Urban land complex, 0 to 5% slopes	51 - Pompano, Feida and Oklawaha soils, depressional
15 - Candler sand, 5 to 12% slopes	54 - Seffner sand
17 - Candler sand, 12 to 25% slopes	55 - Sparr sand, 0 to 5% slopes
18 - Cassia sand	56 - Sparr sand, 5 to 8% slopes
20 - Emerald fine sand, frequently flooded	57 - Tavares sand, 0 to 5% slopes
21 - Eureka loamy fine sand	58 - Tavares-Urban land complex, 0 to 5% slopes
24 - Fellowship fine sandy loam, depressional	60 - Wauchula sand
25 - Immokalee sand	99 - Water